



Advantages:

- high quality power LED of CREE Lighting,
- possibility of connecting stripes in chains,
- safe low operating voltage,
- easy installation,
- wide range of available CCTs (from 2600 K up to 10000 K).

Applications:

- furniture and displays illumination,
- indoor lighting,
- general illumination,
- decorative and accenting illumination.
- museum lighting.

Technical data¹⁾

LED Stripe	Colour	Number of LEDs	Power type ³⁾	Operating current	Power	Viewing angle ²⁾	CCT	Luminous flux	Luminous flux
				[mA] max	[W] max	[°]	[K] typ.	[lm] typ. (I = 350mA)	[lm] typ. (I = max)
LEDIS 9XR-E CW1	Cool white	9	Current: 350mA; 700mA	700	23,4	90	6500	900	1530
LEDIS 9XR-E CW2	Cool white	9		700	23,4	90	6500	720	1224
LEDIS 9XR-E NW	Neutral white	9		700	23,4	90	4300	666	1134
LEDIS 9XR-E WW	Warm white	9		700	23,4	90	3000	603	1024
LEDIS 9XR-C CW	Cool white	9		500	16,2	90	6500	558	810
LEDIS 9XR-C NW	Neutral white	9		500	16,2	90	4300	513	738
LEDIS 9XR-C WW	Warm white	9		500	16,2	90	3000	414	603

¹⁾ All data concern particular module. Values of each parameters are average values and in particular copy they can be differ than in the table above.

²⁾ Maximum angle at which LED intensity value is 50% of maximum intensity, observed at mechanical axis of LED.

³⁾ Choice of power supply type(current/voltage) depends on inner stripe connections and should be consulted with LEDIKO.

Qualities:

- very high luminous flux thanks to 9 LEDs,
- stripes optimized for driving by impulse constant current power supplies,
- parallel connecting with no need for extra wires,
- module prepared for length adjustment thanks to three break sections – lengths available: 14 or 29 cm,
- excellent thermal flow,
- possibility of brightness regulation thanks to PWM with drivers produced by LEDIKO,
- light is emitting orthogonally to plate surface.

Tolerated work parameters¹⁾

LED Stripe	Operating temperature [°C]		Voltage DC [V]	Reverse voltage [V]	Junction temperature [°C]
	min	max	max	max	max
LEDIS 9XR-E CW1	-40	85	36	45	145
LEDIS 9XR-E CW2	-40	85	36	45	145
LEDIS 9XR-E NW	-40	85	36	45	145
LEDIS 9XR-E WW	-40	85	36	45	145
LEDIS 9XR-C CW	-40	85	36	45	145
LEDIS 9XR-C NW	-40	85	36	45	145
LEDIS 9XR-C WW	-40	85	36	45	145

¹⁾ Table of physical work parameters, that must not be exceeded because of possibility of lifetime reduction or permanent damage of LED module.

Drawing and mechanical dimensions

Shape: rectangle, stripe

Dimensions: length 440mm, width 10,8mm

Height: 5,4mm

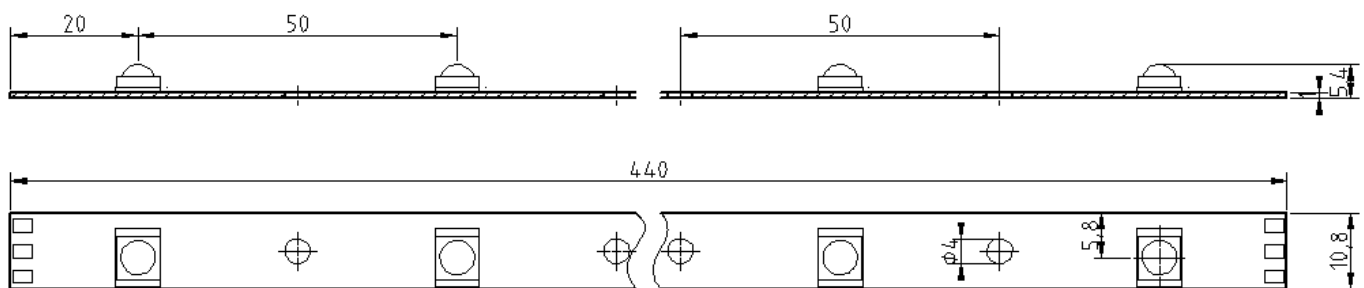

Fig. 1. LEDIS 9XR.

Safety information

1. Stripes must not be weighed down mechanically to work safe.
2. Montage elements must not destroy LEDs or paths on the plate.
3. Stripes have no short circuit, overcharge and thermal protection.
It is absolutely necessary for LED power circuits to have such protections.
4. Stripes installation (with driving circuits) must be in accordance with all electric and safe standards.
5. It is necessary to keep proper polarization of driving voltages. Wrong polarization could cause LED damage.
6. During installation it is important to remember about influence of electrostatic charge. Before installation charges should be neutralized by touching metal parts of grounded elements (e.g. copper pipe, tap, etc.).
7. It is recommended to keep chip temperature below 85°C. In order to draw heat away from LED junction external radiators can be used. Parameters and dimensions of radiator can be computed using proper equations. Each application, depending on number of LEDs, power, montage and many other parameters, need to be processed separately. LEDIKO provides optimal solutions for each customer.
8. LEDs have not corrosion resistant elements. User should provide safe work conditions of circuit. LEDIKO products do not fall within complaint on the basis of damages caused by humidity and chemical conditions.
9. LEDIKO stripes are not appropriate to use direct outdoor or in conditions that may damage electric parts (e.g. low or high temperature, humidity, chemical conditions). In such applications it is necessary to use special package.
10. Package should fulfil such requirements:
 - optical transparency from light emitted side,
 - UV protection (in case of sun light exposure),
 - drawing heat away, to keep safe work of circuit,
 - heat produced by LED resistance,
 - low transmission in all climate conditions.

Mounting directions:

1. LED stripes must be connected to power supply in accordance with all electric and safe standards. Before switching power on it is always required to check all the electric connections and make sure that power supply has proper electric parameters.
2. It is very important to mount stripe to the element which helps to draw heat away (e.g. aluminium plate, radiator). In case of montage using screws, some separators (silicone, mica, silicone paste or other material that conduct heat) are needed between radiator and substrate of the stripe. Such a separator needs to be used, because it helps to transfer heat from the substrate to the radiator and makes LED work conditions better. Stripe can also be mounted to the radiator using special glue or tape, which conduct heat.
3. Depends on the power of power supply it is important to use radiator with proper thermal resistance. When power supply is 1W per LED, radiator should have maximum thermal resistance at a level of 4K/W, it corresponds e.g. aluminium sheet, 2 mm thickness and 225cm² area (e.g. 5cm side flat bar).
4. Mount with two M3 screws (hole diameter \varnothing 3,1mm), head diameter up to 6 mm. Between plate with LEDs and surface where stripe is mounted should be effective thermal contact. Stripe can also be mounted to the surface using special glue or tape, which conduct heat.
5. Connection is made by two wires (in serial or parallel connection) or by three wires in serial – parallel connection. There are some examples below.

Connection details

Examples below show a way of connection a single LEDIS 9XR stripe with current supply(Fig. 2.) and connecting a few stripes in parallel(Fig. 3.).

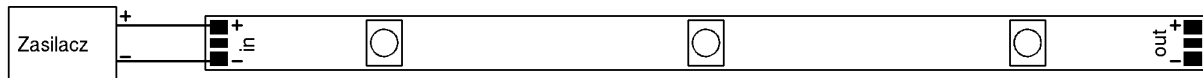

Fig. 2. Single LEDIS 9XR stripe basic connection.

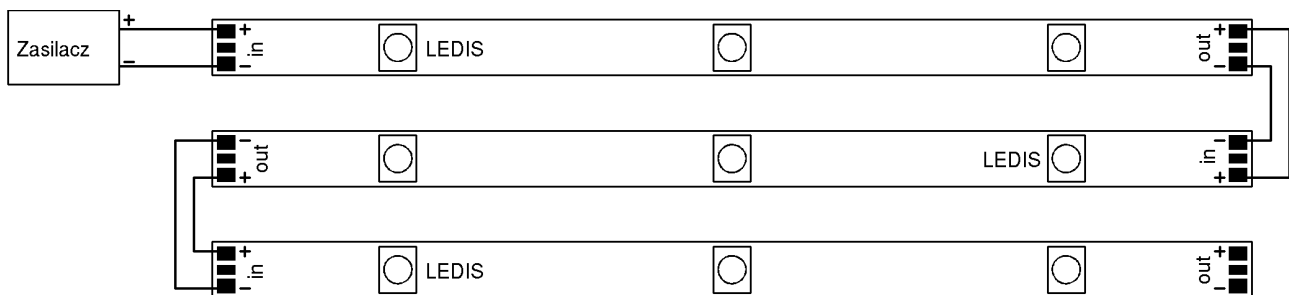

Fig. 3. Three LEDIS 9XR stripes connected in parallel with a single power supply.

Notice: Choice of power supply type(current/voltage) depends on inner stripe connections and should be consulted with LEDIKO.

Order particulars

LED Stripe	Colour	CCT	Typ. luminous flux (350mA)
LEDIS 9XR-E CW1	Cool white	6500 K	900 lm
LEDIS 9XR-E CW2	Cool white	6500 K	720 lm
LEDIS 9XR-E NW	Neutral white	4300 K	666 lm
LEDIS 9XR-E WW	Warm white	3000 K	603 lm
LEDIS 9XR-C CW	Cool white	6500 K	558 lm
LEDIS 9XR-C NW	Neutral white	4300 K	513 lm
LEDIS 9XR-C WW	Warm white	3000 K	414 lm

When placing an order please write:

1. Name and surname of orderer,
2. Company name,
3. Company Tax Identification Number,
4. Address of company or private address for individual customers,
5. City and post code,
6. Index of elements: number of elements, product code.

Welcome to contact us and place orders.
Phone: +48 71 79 85 785

www.lediko.com



Notice: "LEDIKO Walendowski i Wilanowski" Sp.J. stipulate the information in this document is subject to change without notice.